

感谢您使用芝杜 zidoo 旗下产品，您可以关注我们的社交平台账号，和我们  
一起交流与分享。

Thank you for choosing products of Zidoo. Friend us on WeChat or Weibo to  
communicate and share with us.



微信公众号 @ **zidoo**  
WeChat Official Account



微博账号 @ 芝杜官方  
Weibo Account



Facebook @ **zidootv**



Twitter @ **zidootv**

如需更多帮助，请访问芝杜 zidoo 官网的用户论坛进行咨询

If you need more assists, please visit user forum of the official website of  
Zidoo for consultation.



官网网址 /Official website: [www.zidoo.tv](http://www.zidoo.tv)

## INTRODUCTION TO HARDWARE OF X20

### Device interface

Zidoo X20 is equipped with audio input and output ports and data transmission port. Please refer to the descriptions in this manual.

#### 1.Front

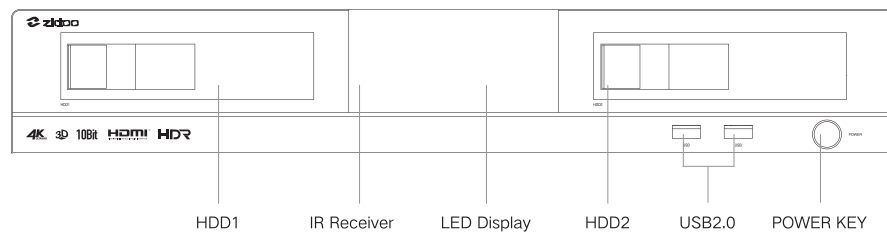

#### 2.Back

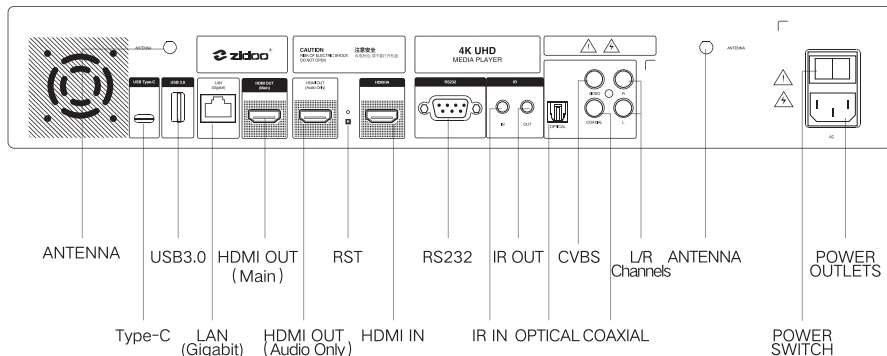

Instruction to installation of the antenna: Please insert the two antennas in the parcel into the antenna ports in the above diagram.

#### Notices:

\*Please load/change the hard disk after turning off the power. If it is a brand-new hard disk, please load it after formatting it.

\*Please prevent the orifice of the cooling fan from being blocked.

\*Do not touch any liquid in case the liquid runs into the inner part of the device and damages it.

\*Any maintenance personnel who are not appointed are not allowed to open the case.

## X20 PERFORMANCE PARAMETER

|   |   |
|---|---|
| <b>Material</b>                                       | Space Aluminium   |
| <b>Display</b>  | LED Display   |
| <b>Material</b>                                       | Aviation Aluminum alloy case  |
| <b>OS</b>   | Android + OpenWRT(NAS) dual system run simultaneously   |
| <b>CPU</b>  | RTD1296 ARM Cortex-A53 Quad-Core  |
| <b>GPU</b>  | ARM T820 MP3(3-core)  |
| <b>Memory</b>   | 2GB DDR4  |
| <b>Internal Storage</b>                               | 16GB eMMC   |
| <b>Wifi Connectivity</b>                              | IEEE 802.11a/b/g/n/ac 2*2 MIMO  |
| <b>Ethernet</b>                                       | 1*RJ-45 (10/100/1000Mbps)   |
| <b>Bluetooth</b>                                      | BT4.1   |
| <b>HDMI2.0a Main output/<br/>HDMI1.4Second Output</b> | Audio and video separation output ; Support 4K@60fps 10Bit  |
| <b>HDMI Input/<br/>HDMI2.0</b>                        | Support 4K60 HDMI   |
| <b>Video Decode</b>                                   | HDR , Support 4K H.265 10Bbit   |
| <b>Video Player</b>                                   | Support 4K UHD; auto frame-rate switch;<br>3D Play; Subtitle Download;<br>ASS/SSA effect Subtitle; Media center |
| <b>Audio Decode</b>                                   | Support HD audio decode and pass through Redesigned Native Player   |
| <b>Audio Interface</b>                                | 1* Composite video output; 1*coaxial output; 1*SPDIF output; 1*RCA Left and right channels output               |
| <b>USB</b>  | 1*USB3.0; 2*USB2.0; 1*TYPE C  |
| <b>HDD BAY</b>  | Support SATA 3.0*2  |
| <b>Input</b>  | 100-240V-50/60Hz Max 1.3A   |
| <b>Others</b>   | 1*RS232; 1*IR Output; 1*IR Input  |

## LOADING HARD DISK

X20 PRO/X20 with two 3.5 inches HDD. SATA high-speed device coffret.  
Please slowly push 3.5 inches hard disk with SATA interface toward HDD  
without any tools (Hard Disk support 10TB Maximum)

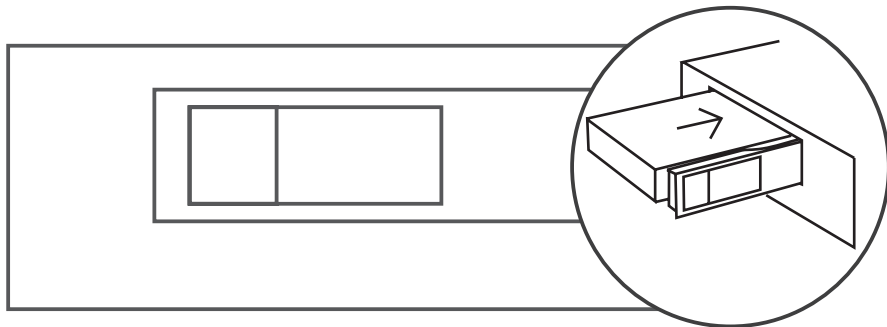

Notice:  
Please do not loading or changing the Hard Disk when the power on and in order to avoid damage  
the Disk and Data. This device support filesystem :EXT3,EXT4,NTFS,FAT32,EXFAT.

## REMOTE CONTROL

### 1.Description of functions of buttons

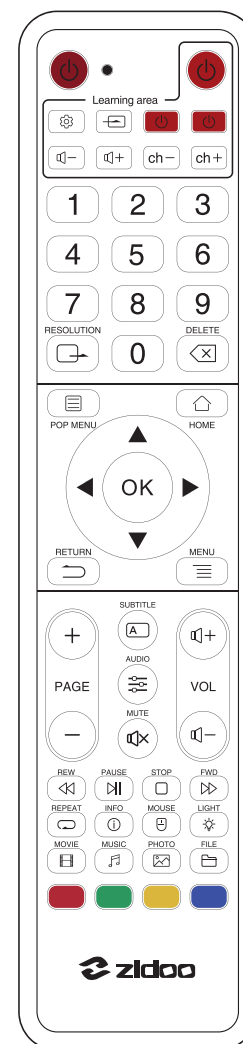



| FUNCTIONS               | KEYS                       |
|-------------------------|----------------------------|
| Power                   |                            |
| LEARNING AREA           |                            |
| NUMBERS                 | <b>1/2/3/4/5/6/7/8/9/0</b> |
| RESOLUTION              |                            |
| DELETE                  |                            |
| POP MENU                |                            |
| HOME                    |                            |
| RETURN                  |                            |
| MENU                    |                            |
| SUBTITLE                |                            |
| AUDIO                   |                            |
| VOL+/VOL-/MUTE          |                            |
| PAGE+/PAGE-             | <b>+</b> <b>-</b>          |
| REW/PAUSE/STOP/FWD      |                            |
| REPEAT/INFO/MOUSE/LIGHT |                            |
| MOVIE/MUSIC/PHOTO/FILE  |                            |
| FUNCTION KEYS           |                            |

## 2.Introduction to Learning button

Learning function: This remote control can copy functions of buttons of other remote control so that it can control two devices.

Operation descriptions of Learning button:

- 1) 1. Press  KEY for 3 sec until indicator light Always-On;
- 2) Press Learning KEY when indicator light blinking;
- 3) Let two remote controller Infrared emission windows with approximately 3cm distance, then press other remote controller Learning KEY. If learning progress works, indicator light stop blinking, by the analogy, apply to other Learning KEY, Press  KEY to exit the learning model.
- 4) Press Light KEY to turn on/off Backlight.

## 3. Bluetooth Pairing

Control remote is aimed at the machine within 30cm. Meantime press Down Key and Menu Key for least 5s until the indicator light blinking which pairing succeed.

## Connection with Device

### 1.HDMI connects to the TV.

X20 PRO/X20 have two ways to connect HDMI. One is stand-up output mode and another one is Double output mode.

- 1) Cut off the power of the device. Please make sure the power of both the TV and Media Player are off.

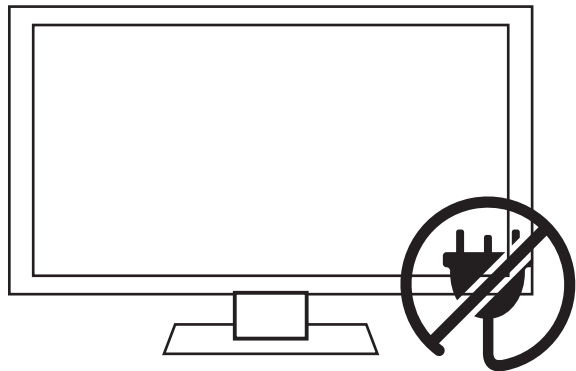

- 2) Stand-up Output mode: While the power of TV and Media Player is off, insert one end of HDMI cable into HDMI OUT and insert the other end into HDMI IN port.

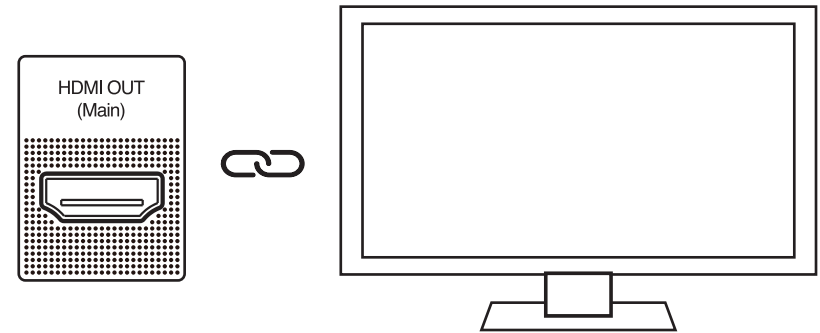

- 3) Double Output mode (The video is separated from the audio): While the power of TV and Media Player is off, make the connection between one side of HDMI cable with HDMI OUT AUDIO ONLY interface. Another side with amplifier.

Then use another HDMI cable connect with HDMI OUT MAIN interface. Another side with TV HDMI IN interface.

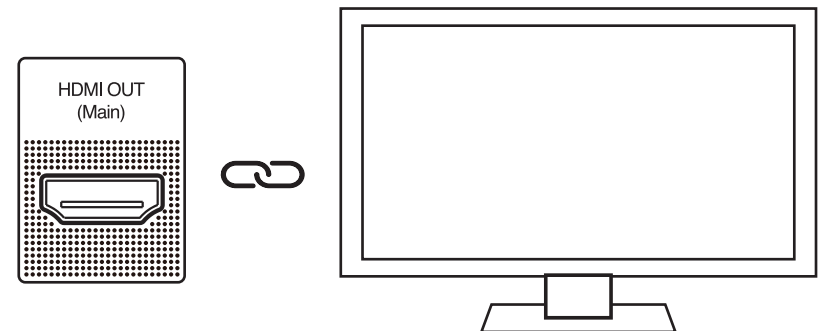
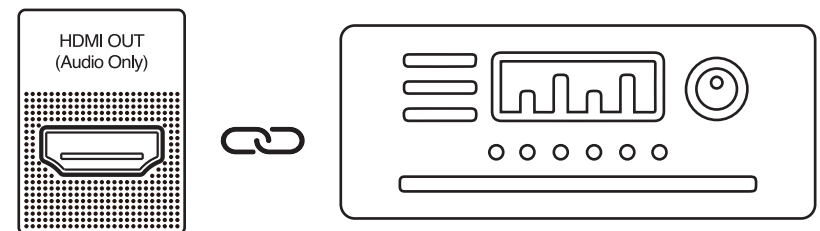

4) Connect with the power. This device is equipped with suitable AC power adapter. Please connect the head of AC power adapter to the AC power input port of this device, then insert the plug of AC power line into the alternating current socket of 110V -240V.

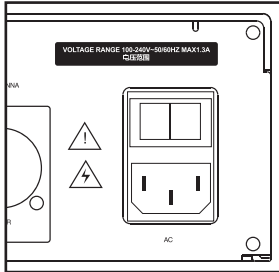

5) Press the right bottom side button or the power button on the remote control to turn on, then turn on the TV.

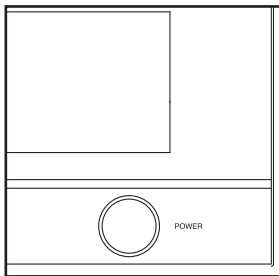

6) Corresponding video source is selected by TV.

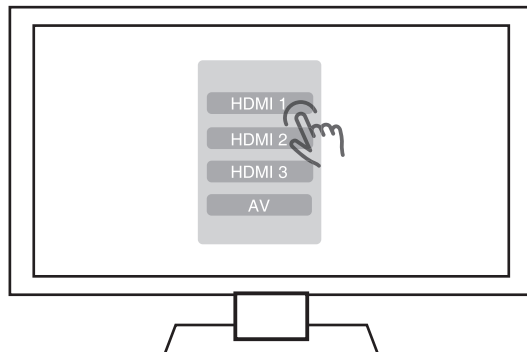

## 2.Connect AV cable with the TV

The connection method is same as that of HDMI cable. Please connect the AV cable before energizing.

## HDMI & AUDIO PROCESSING

### 1. HDMI Output Setting

If apply double HDMI output mode which the main port access to TV or Projection, deputy port with power amplifier. Three mode to choose.

1) Master Port and Subport Separation Model: Video is outputting from main port, audio is outputting from deputy port and achieve Great Separation.

2) Master Port + Subport Model: Main port is outputting voice and video, deputy port is outputting audio.

3) Master Port Mode: Main port outputting audio and video, deputy port without audio.

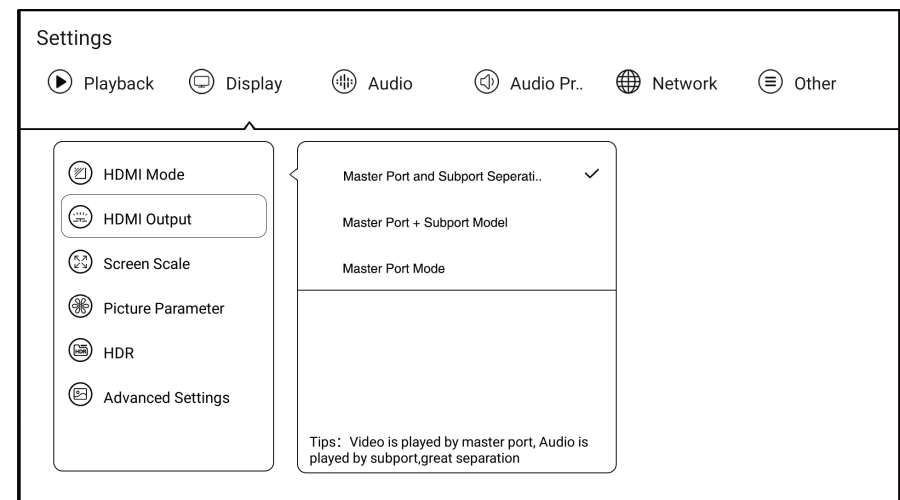

### 2. Analog Audio Processing(Only for X20 PRO)

#### 1) Switch of analog audio

If you need to analog output, you must turn on the button. When you turn it on, HDMI audio output setting will automatic decode stereo. In the same way, If set HDMI audio output to passthrough output or auto-output, the switch will automatic turn off.

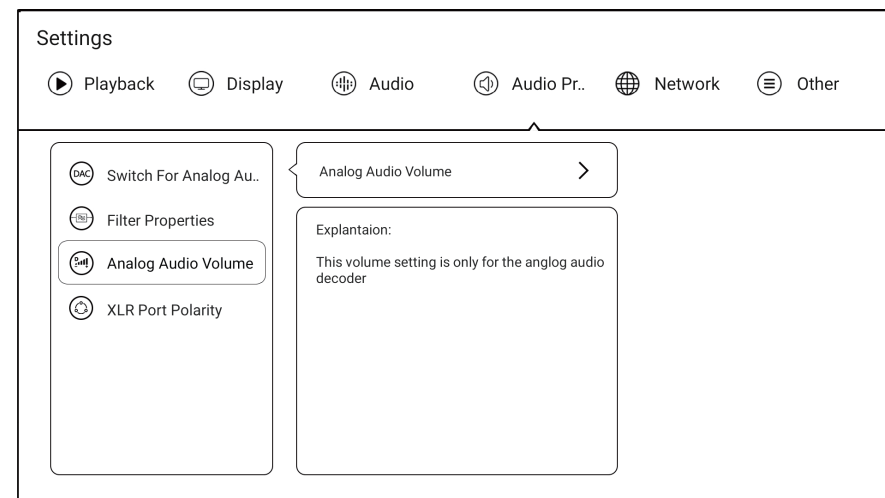
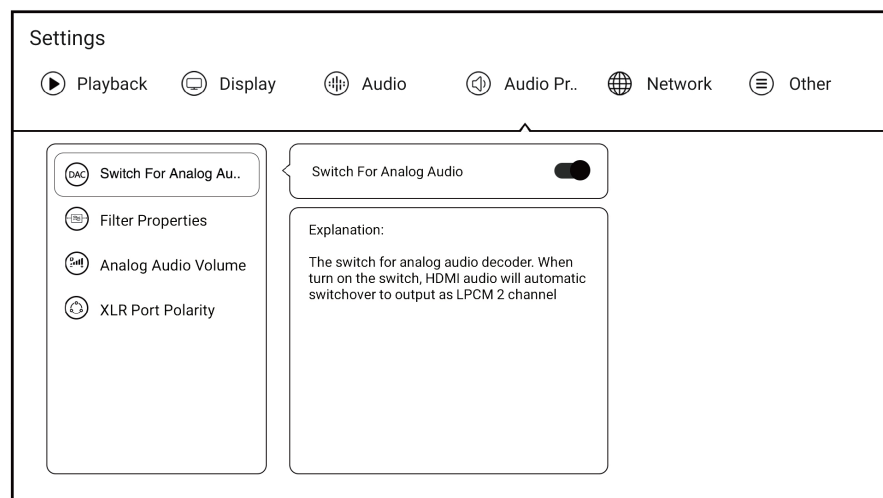

## 2) Filtering Features

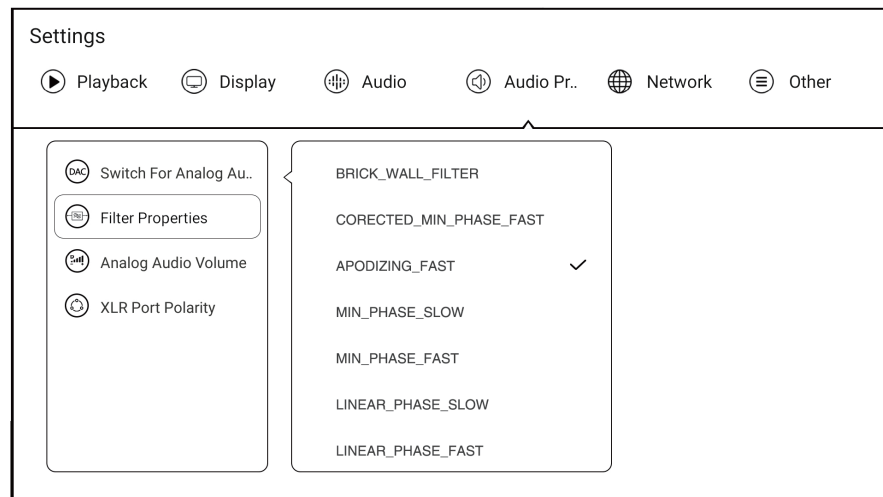

## 4) XLR Port polarity

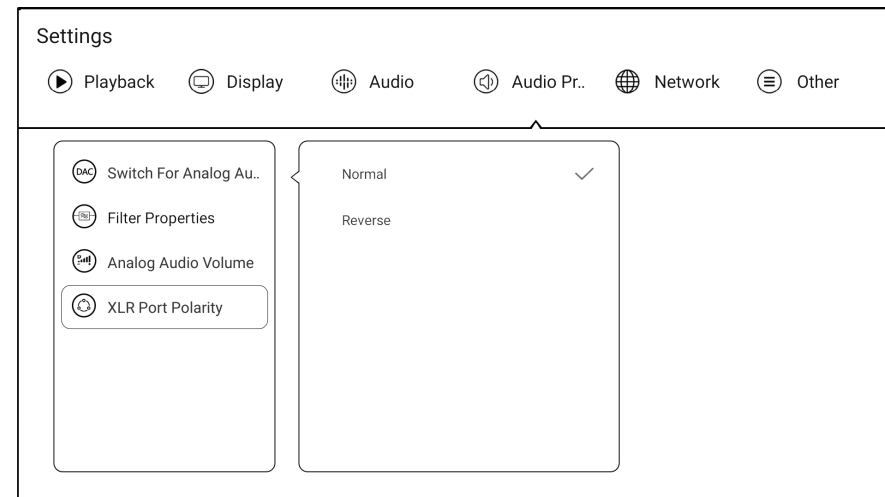

## 3) Analog Audio Volume

This Setting is only for DAC decoder, audio value is DAC Decoder Volume value.

## INITIALIZATION

Before actually using this device, this software will provide you for first initialization. Please set your device according to the initialization process to obtain the optimum watching experience.

### 1. Language of the system

Select the language of the system as you need.

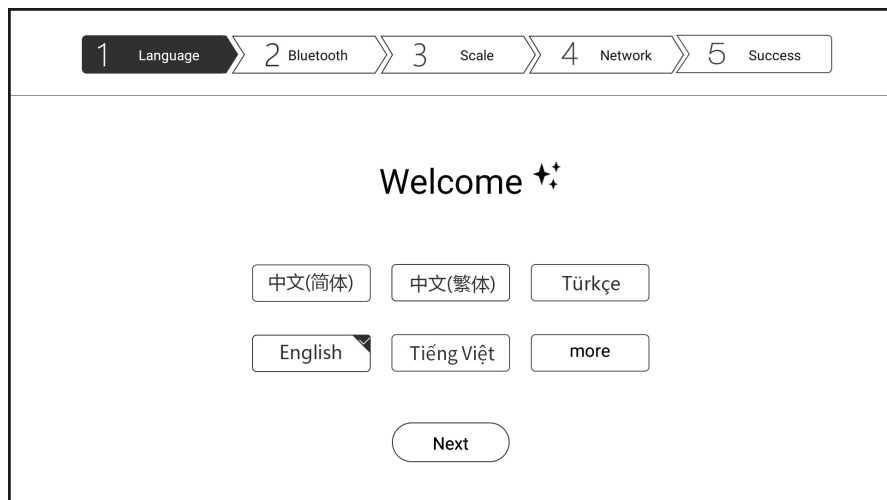

### 2. Bluetooth Match-Up

Let remote controller be aligned with Player and press Page-Down KEY and Menu KEY at the same time for least 5 second until indicator light blinking which matching succeed.

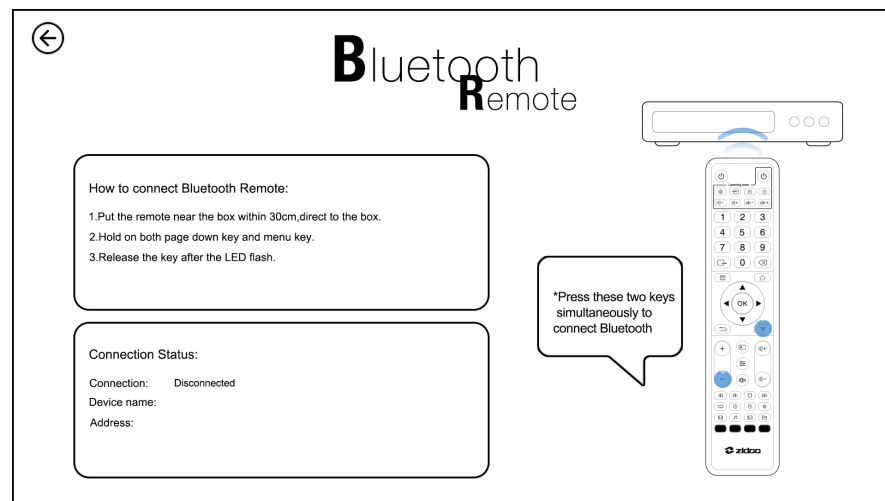
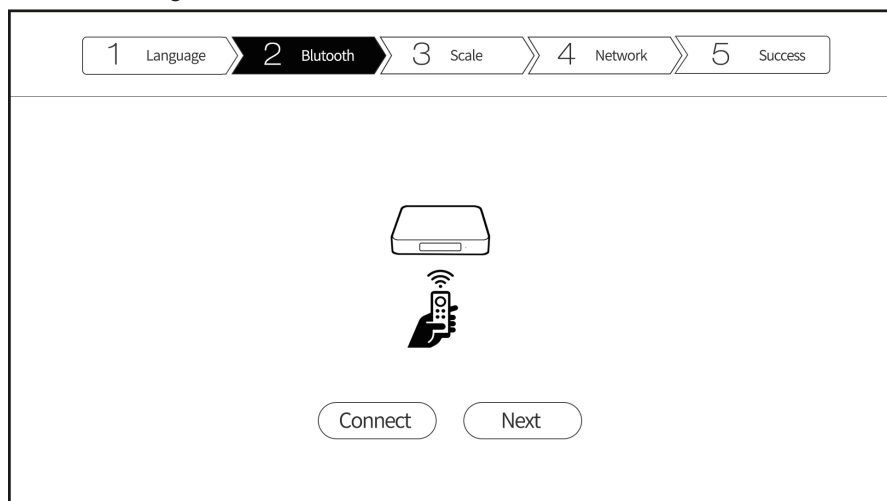

### 3. Screen scaling

Adjust the screen display range using LEFT or RIGHT button of the remote control or the mouse wheel so that the image can be displayed on the screen of the TV.

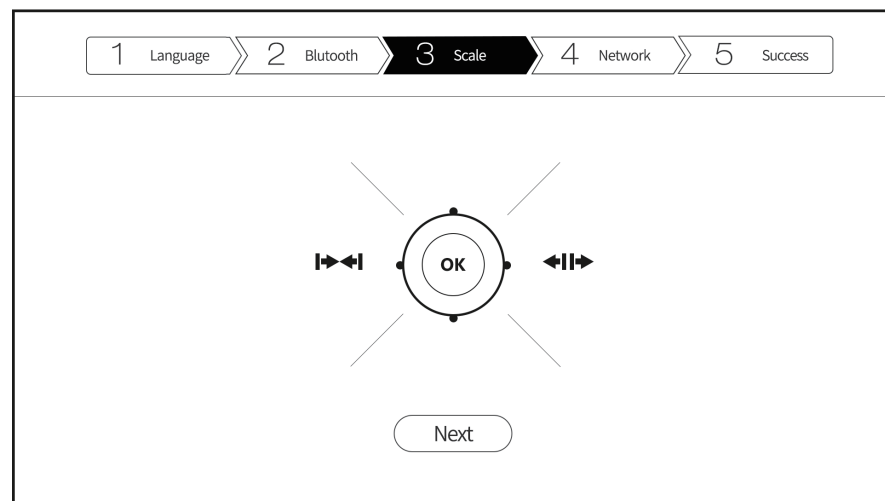

#### 4. Network settings

Adjust the screen display range using LEFT or RIGHT button of the remote control or the mouse wheel so that the image can be displayed on the screen of the TV.

WIFI: Select SSID and enter password, connect to WIFI and finish setting;

#### SYSTEM UPDATE BY OTA

Zidoo will update the firmware aperiodicity.

Find the system update icon in APP center and open it; support online network update and local update; after ticking "automatically detect the latest version", will receive the prompt for the latest firmware update automatically.



## 2. Local update

Users can download the update file on the forum or official website and update firmware by local update.

Copy the downloaded update file to USB disk. Click "local update" to select the update file.

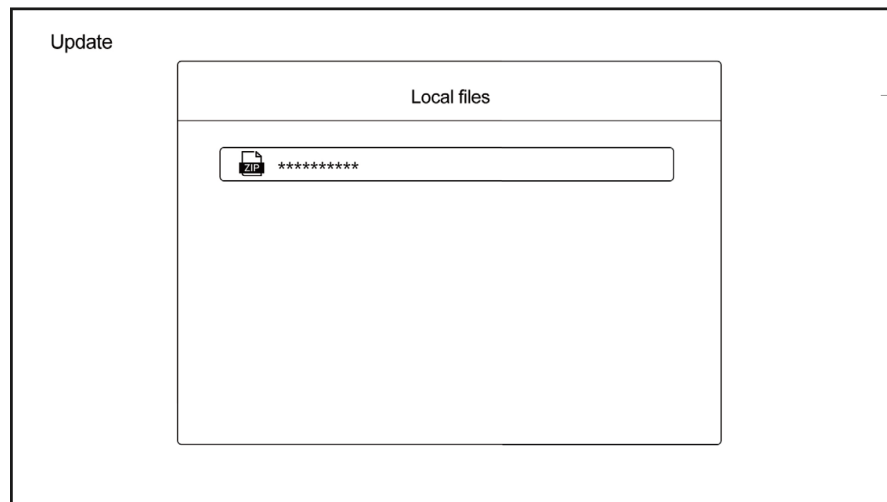

Download the update file by online update or local update. Click "update" to update.

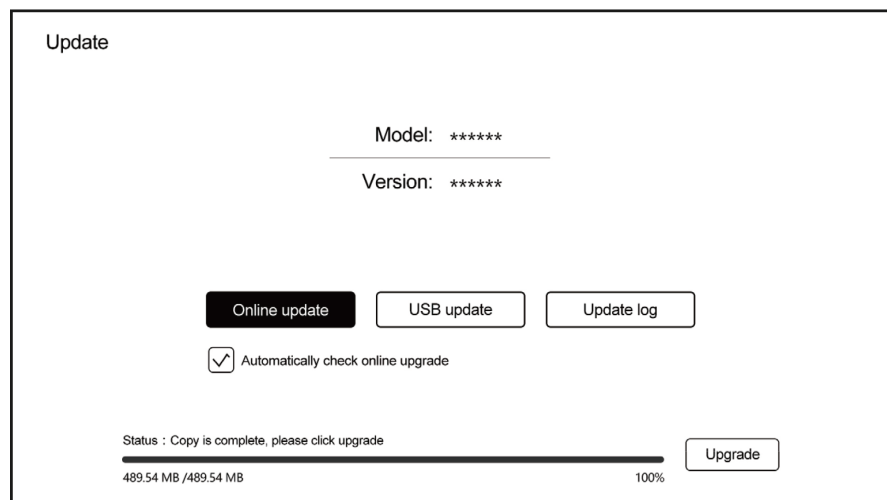

The system will automatically check the update file whether is complete or not.

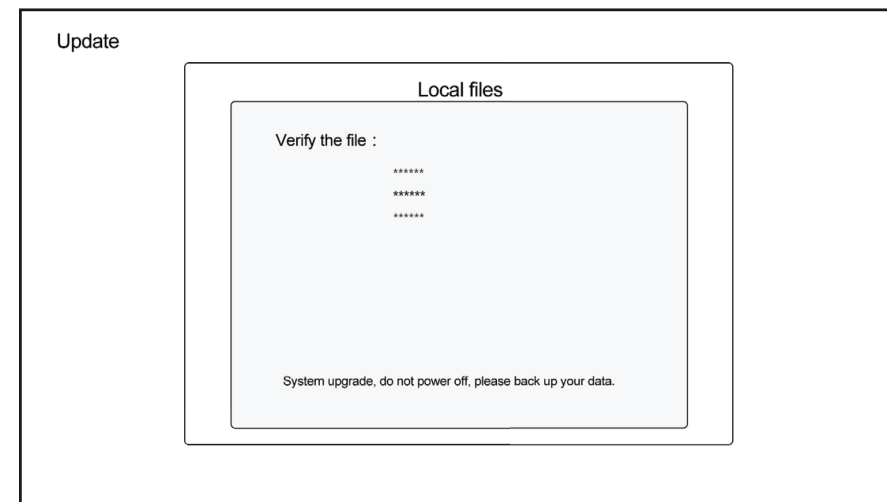

Note: Download the update file by online update or local update. Click "update" to update.

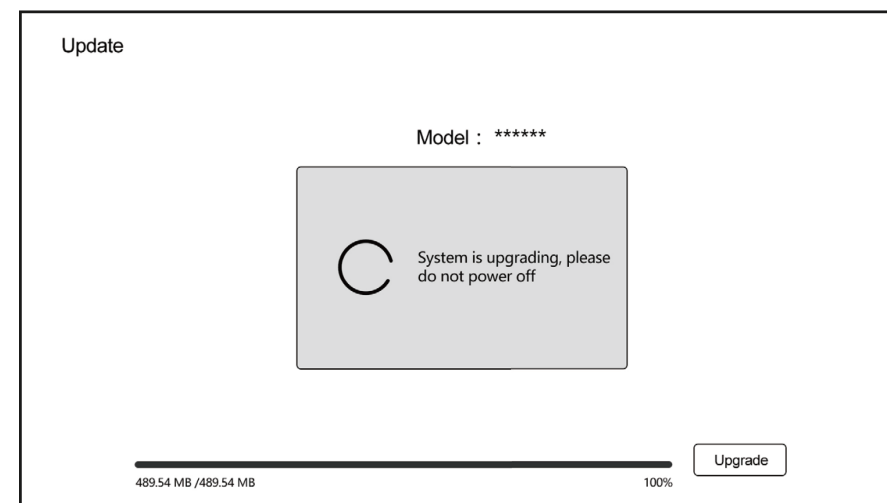

Once the update is completed, the system will automatically be restarted.



### **Special note:**

To guarantee user experience, Zidoo will update the firmware aperiodicity. Therefore, this manual may not be totally in line with the product.

### **Warning notice:**

1.The equipment shall not be subjected to water splashing or water drop, and shall not be placed on the device such as a vase, which is full of liquid.

2.The disconnecting device of this product is the power plug. The socket provided to this product should be installed near the product, and should be easy to operate and cannot be blocked by other objects.

3.This product is classified as I equipment, and it must have grounding measures inside the time box.